

## Sparsholt Information Sheet

Sparsholt College Hampshire,  
Westley Lane, Sparsholt, Winchester SO21 2NF  
Main Reception (01962) 776441 / Sparsholt Events (01962) 797259

### DIRECTIONS TO SPARSHOLT COLLEGE

**Caution** if you are using satellite navigation devices, please be aware of using the narrow roads around Sparsholt Village, we would recommend you NOT use the Sparsholt Village access. The lane are single track roads and get very busy and have limited passing areas, and we don't want to overload the village with traffic.

Please use the Stockbridge Road (B3049) to access the Campus. What3words are below.

#### **What3words for the college.**

Stockbridge Road Entrance (B3049) ///parsnips.chins.youths

College Entrance – ///compelled.headrest.storm

INTERNET LINK - <https://what3words.com/parsnips.chins.youths>

Once on campus please follow HILLSIDE ROAD and turn left onto CHUTE HILL and follow the road up to Hampshire Rural Business Centre. There is Parking up at the business centre, or you can park in the Sainsbury Carpark further down.

**From SOUTH via M3 avoiding Winchester City Centre** – Travel north on M3 and leave at Junction 11 (A3090) signposted Winchester S & W. Go straight over 1st roundabout. At 2nd roundabout take 2nd exit on to Badger Farm Road signposted *Olivers Battery (A3090)*. Continue up hill. Go straight over 1st roundabout, at 2nd roundabout take 2nd exit on to Romsey Road signpost *City Centre*. Go through 2 sets of traffic lights. At mini roundabout take 1<sup>st</sup> exit onto Chilbolton Avenue signposted *City Centre - All Other Routes*. Follow to end and then turn left at mini roundabout on to Stockbridge Road signposted *Stockbridge – Salisbury (A3049)*. Proceed on this road for approximately 2.5 miles (ignoring signs to the village of Sparsholt). Turn left at the Sparsholt College Hampshire. Continue up the lane for approximately 0.5 miles, turning right on to campus.

**From LONDON via M3 avoiding Winchester City Centre** – Travel south on M3 and leave at junction 9 (A272) signposted *Winchester*. At roundabout take 4th exit signposted *Newbury (A34) – Stockbridge*. Proceed in left hand lane for approximately 3 miles and leave at 1st exit signposted *Salisbury (A30)*. At roundabout (Three Maids Hill) take 2nd exit signposted *Winchester (B3420)*. Continue downhill past Army Training Regiment Camp. Take next right over brow of hill signposted *Harestock* into Harestock Road. Proceed on this road for approximately 1 mile to T-Junction. Turn right, on to road signposted *Stockbridge*. Proceed on this road for approximately two miles (ignoring signs to the village of Sparsholt). Turn left at Sparsholt College Hampshire. Continue up lane for approximately 0.5 miles, turning right on to campus.

**From MIDLANDS and THE NORTH via A34** – Travel South on the A34 and leave at exit for Winchester (B3420). Go straight over mini roundabout and continue over the bridge to next roundabout (Three Maids Hill). Take second exit signposted *Winchester (B3420)*. Follow directions from London.

**From EAST via A31 or A272** – Join the M3 southbound at Junction 10. Exit M3 at Junction 11 signposted *Winchester*. At bottom of slip road turn right at the traffic lights. Continue under motorway and turn left at next set of traffic lights. At the roundabout take the second exit for Winchester and at the next roundabout take second exit on to Badger Farm Road, signposted *Olivers Battery (A3090)*. Follow directions as per South via M3.

**Train Station - Station Road, (Off Newburge Street) Winchester, SO23 8TJ**

Train Station (Enquiries) (03457) 484950

The station is a 10min taxi journey to and from the college, and there are always taxi's waiting outside.

Locals Taxi companies –

Wessex Cars (01962) 866208 & Wintax (01962) 878727

**What3words for the college.**

**Accommodation Info**

**Halls (Crawley, Dean & Littleton)**

Single Ensuite Bedrooms, WiFi, Linen and Towels provided. Communal Tea/coffee area.

Check in on Arrival Day is from 15:00PM

Check Out on departure Day is 12:00PM

**Hampshire Rural business centre**

Single Ensuite Bedrooms, with TV, Wifi and Small kettle, tea/coffee. Linen and Towels provided.

Check in on Arrival Day is from 15:00PM

Check Out on departure Day is 12:00PM.

All Keys MUST BE handed in by 12pm (Mid-day) on the Sunday.

## **Sparsholt College Campus Rules & Guidelines**

- All visitors using the Car Parks for entering any part of the College property with any kind of motor vehicle do so entirely at their own risk, whether to themselves, their passengers, the vehicle or its contents or to any other party. Nothing of value should ever be left in a vehicle. The College will not be responsible for any loss of or damage to any vehicle or anything contained therein or thereon howsoever the loss or damage may be caused.
- There is a NO SMOKING policy in and near all buildings, please only use the designated smoking shelters. And we have a NO VAPING policy in all buildings, halls and bedrooms.
- Sparsholt complies with Safeguarding Legislation as set out in The Children's Act 1989. In order to protect you from allegations and to safeguard our students please comply with the following requests: Do not encroach on student only areas such as halls of residence, other than where you are do not exchange mobile phone numbers or make friends on Facebook or any other social media with students.
- We are a large land-based college, and we have 450 acres of land, with many different areas on the campus. We encourage people to please walk around, but we ask you to please respect some areas. Please take note of "No Entry" signs and notices. We have the Zoo (Animal management centre), Kennels, farm buildings and more that are out of bounds.
- Lanyards/ Visitor Badgers should be worn at all times on site, Our Duty wardens and Site Duty Managers know what events and clubs are coming to site at the weekend and have the right to stop anyone they see on site walking or waiting around without an ID/Lanyard. If you are asked, please inform them who you are with.
- We DO NOT allow any Dog to visit site. Guest visiting the college are not to bring dogs onto the campus, to walk then or leave in their car. We have Animals on site that we must look after. We do not know what vaccinations or behavioural training other dogs have so they are not allowed on site.
- In case of first Aid or emergency, you must contact your events organiser/Supervisor.
  - It is for the events leader to call any emergency services that is needed, and then call the duty manager on the Sparsholt campus.
  - We have an AED (Defibrillator) on the outside of the Wardens Office & wall of the Sport Centre.
  - It is for the events organiser/team to bring their own First Aid kit, and to fill in their own Accident report. A copy can be sent to us for our records if you deem necessary.
- We ask that you please respect our campus, keep it clean and tidy and put all your rubbish in the bins.

We thank you in advance for adhering to these guidelines.

## Sainsbury Building (43)

### Ground Floor

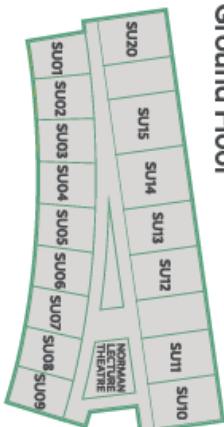

## Lower Ground Floor



## Saxony, Pod (29)

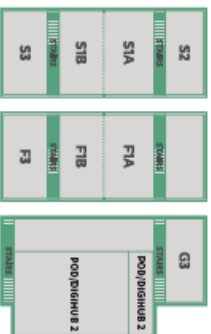

## Engineering (15)

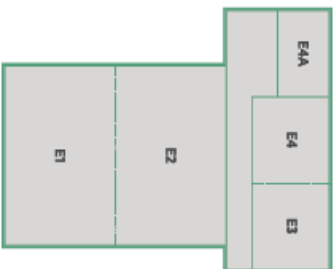

- Staff Parking
- Student/Visitor Parking
- Accessible Parking
- Disabled Access Toilets
- Toilets
- Laundry
- Bus Stop
- Catering Facilities/Shop
- Smoking Shelters
- Vaping Only Shelters
- Classrooms
- Coach Stops

**RIFLE RANGE**  
100m FULL BORE

**NO RECREATIONAL ACCESS**

- 1 Additional Learning Support
  - 2 Agricultural Engineering Workshops
  - 3 Animal Health & Welfare Research Centre
  - 4 A Chester
  - 5 B Exmoor
  - 6 C Jersey
  - 7 D Longleat
  - 8 E Marwell
  - 9 F Palsgrove
  - 10 G Veterinary Nursing Training Centre
  - 11 H Whippsnade
  - 12 I Arb & Forestry Climbing Poles
  - 13 J Aquatic Research & Conservation Centre
  - 14 K Beef Barn
  - 15 L The Kitchen @ SO21
  - 16 M Cattery
  - 17 N Changing room (away)
  - 18 O Changing room (home)
  - 19 P Chute Boardroom & Terryson
  - 20 Q Chute Hall
  - 21 R College Lane and Wetland Area
  - 22 S Demo Shed
  - 23 T Dog Grooming & Hydrotherapy Pool
  - 24 U Engineering and Motor Vehicle Workshops
  - 25 V Engineering Building
  - 26 W Equine Centre featuring the Rider Performance Studio
  - 27 X Equine Cross Country Course
  - 28 Y Equine Outdoor Arenas
  - 29 Z Farley Pre-School Nursery
  - 30 AA Foundation Learning Centre
  - 31 AB Foundation Learning Kitchen
  - 32 AC Game and Wildlife Centre
  - 33 AD Gardeners' Question Time
  - 34 AE Potting Shed & Garden
  - 35 AF Garston Dairy
  - 36 AG Glass House
  - 37 AH Hampshire Rural Business Centre
  - 38 AI HE Study Centre
  - 39 AJ Horticulture Nursery
  - 30 Information Communication Technology Centres
  - 31 Jane Austen Suite
  - 32 Landscape Construction
  - 33 Library and DigHub
  - 34 Library Gardens
  - 35 Lily Pond
  - 36 Main College Reception
  - 37 Mitchell Wing
  - 38 MU's
  - 39 100m Full Bore Rifle Range
  - 40 New driving plot
  - 41 Orchard
  - 42 Owers Wood
  - 43 Pig Unit
  - 44 Premises Office
  - 45 Sainsbury Building
  - 46 Salmonid Rearing & Trials Centre
  - 47 Sawmill
  - 48 Sheep Barn
  - 49 Sports Centre
  - 50 Sports fields
  - 51 Support Hub (including Wellbeing)
  - 52 Tennis Court
  - 53 Tropical House
  - 54 Warden's Office
  - 55 Westley Farm Buildings
  - 56 25m Indoor Rifle Range
  - 57 Old Rec Hall
- STUDENT ACCOMMODATION**
- A Brock
  - B Crawley
  - C Dean
  - D Dymoke White
  - E Filindt
  - F Littletton
  - G Rose
  - H Palmer
  - T Portchester
  - J Steele
  - K Sturgess

24 hour CCTV in operation on site