

# SPARSHOLT

CONFERENCES & EVENTS

## SPARSHOLT CAMPUS

### Sainsbury Building (43) Ground Floor

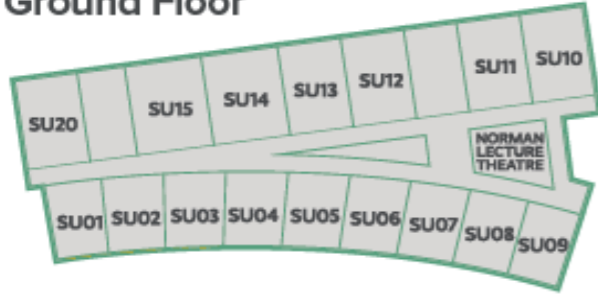

### Sainsbury Building (43) Lower Ground Floor



### Saxony, Pod (29)



### Engineering (15)

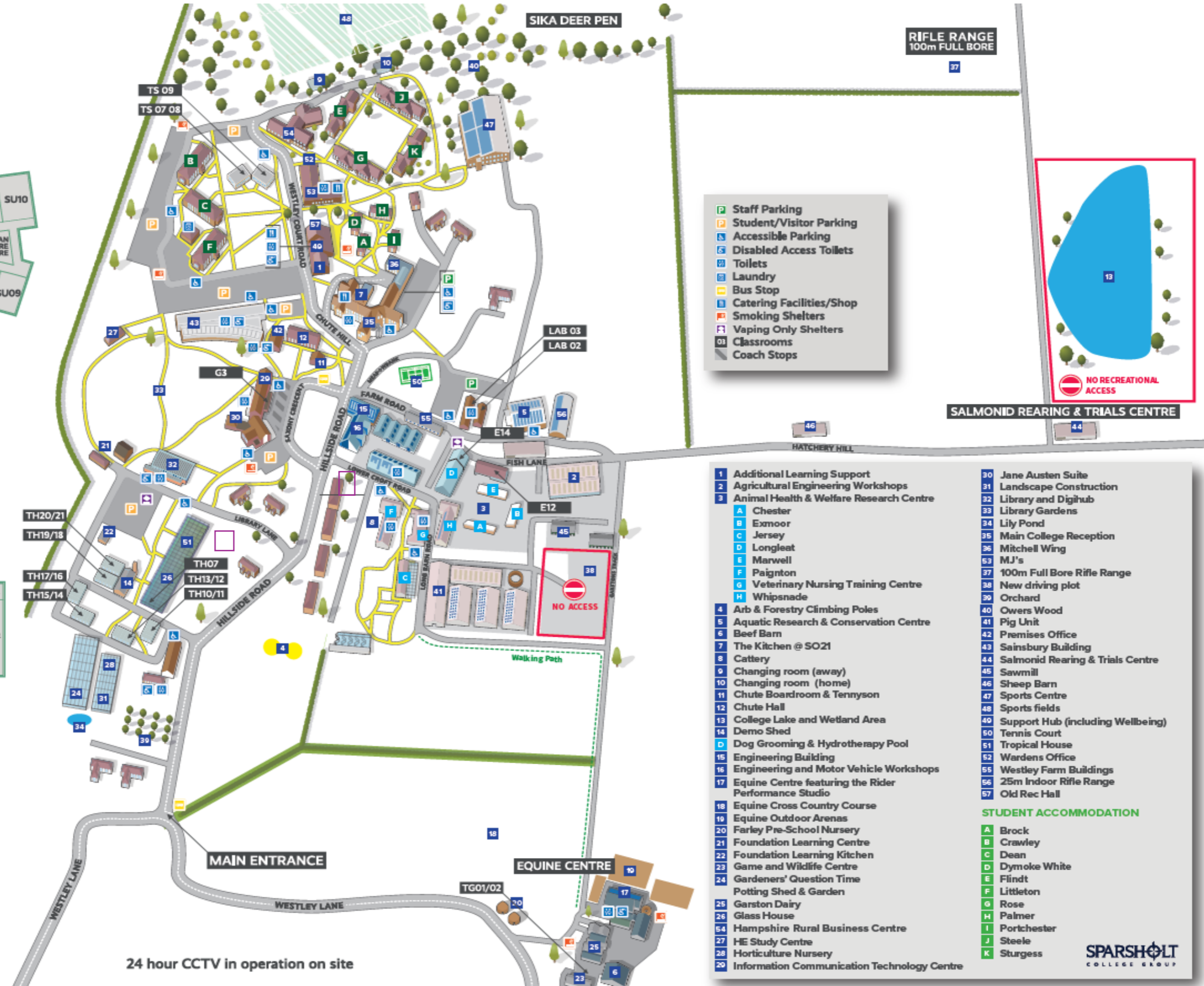
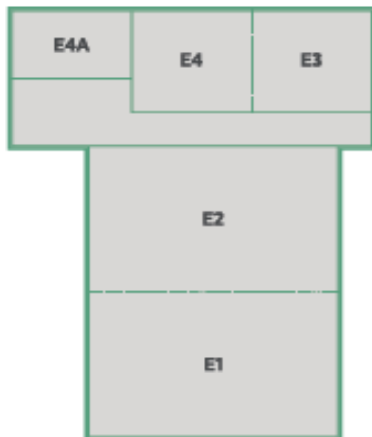

- Staff Parking
- Student/Visitor Parking
- Accessible Parking
- Disabled Access Toilets
- Toilets
- Laundry
- Bus Stop
- Catering Facilities/Shop
- Smoking Shelters
- Vaping Only Shelters
- Classrooms
- Coach Stops

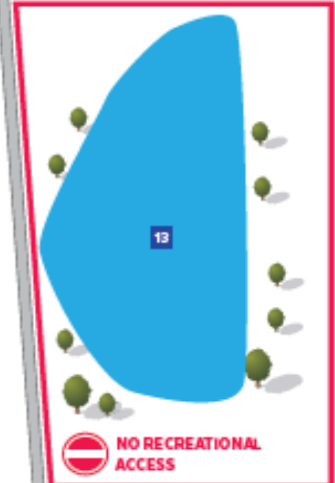

- |  |   |
|--|---|
| <ul style="list-style-type: none"> <li>1 Additional Learning Support</li> <li>2 Agricultural Engineering Workshops</li> <li>3 Animal Health &amp; Welfare Research Centre</li> <li>A Chester</li> <li>B Exmoor</li> <li>C Jersey</li> <li>D Longleat</li> <li>E Marwell</li> <li>F Paignton</li> <li>G Veterinary Nursing Training Centre</li> <li>H Whipsnade</li> <li>4 Arb &amp; Forestry Climbing Poles</li> <li>5 Aquatic Research &amp; Conservation Centre</li> <li>6 Beef Barn</li> <li>7 The Kitchen @ SO21</li> <li>8 Cattery</li> <li>9 Changing room (away)</li> <li>10 Changing room (home)</li> <li>11 Chute Boardroom &amp; Tennyson</li> <li>12 Chute Hall</li> <li>13 College Lake and Wetland Area</li> <li>14 Demo Shed</li> <li>15 Dog Grooming &amp; Hydrotherapy Pool</li> <li>16 Engineering Building</li> <li>17 Engineering and Motor Vehicle Workshops</li> <li>18 Equine Centre featuring the Rider Performance Studio</li> <li>19 Equine Cross Country Course</li> <li>20 Equine Outdoor Arenas</li> <li>21 Farley Pre-School Nursery</li> <li>22 Foundation Learning Centre</li> <li>23 Foundation Learning Kitchen</li> <li>24 Game and Wildlife Centre</li> <li>25 Gardeners' Question Time</li> <li>26 Potting Shed &amp; Garden</li> <li>27 Garston Dairy</li> <li>28 Glass House</li> <li>29 Hampshire Rural Business Centre</li> <li>30 HE Study Centre</li> <li>31 Horticulture Nursery</li> <li>32 Information Communication Technology Centre</li> </ul> | <ul style="list-style-type: none"> <li>30 Jane Austen Suite</li> <li>31 Landscape Construction</li> <li>32 Library and Digihub</li> <li>33 Library Gardens</li> <li>34 Lily Pond</li> <li>35 Main College Reception</li> <li>36 Mitchell Wing</li> <li>37 MJ's</li> <li>38 100m Full Bore Rifle Range</li> <li>39 New driving plot</li> <li>40 Orchard</li> <li>41 Owers Wood</li> <li>42 Pig Unit</li> <li>43 Premises Office</li> <li>44 Sainsbury Building</li> <li>45 Salmonid Rearing &amp; Trials Centre</li> <li>46 Sawmill</li> <li>47 Sheep Barn</li> <li>48 Sports Centre</li> <li>49 Sports fields</li> <li>50 Support Hub (including Wellbeing)</li> <li>51 Tennis Court</li> <li>52 Tropical House</li> <li>53 Wardens Office</li> <li>54 Westley Farm Buildings</li> <li>55 25m Indoor Rifle Range</li> <li>56 Old Rec Hall</li> </ul> <p><b>STUDENT ACCOMMODATION</b></p> <ul style="list-style-type: none"> <li>A Brock</li> <li>B Crawley</li> <li>C Dean</li> <li>D Dymoke White</li> <li>E Flindt</li> <li>F Littleton</li> <li>G Rose</li> <li>H Palmer</li> <li>I Portchester</li> <li>J Steele</li> <li>K Sturgess</li> </ul> |
|--|---|

24 hour CCTV in operation on site